

# BORA lighting

PLANNING DOCUMENTS

# BORA Horizon Highlights

## Convenient operation

The BORA Horizon can be adjusted without tools: With the fixed version, the height can be adjusted using the stop beads on the ceiling housing, and with the Move version the height can be adjusted on the lighting fixture itself so that it can be adapted to the conditions in your cooking and dining area. The BORA Horizon can easily be gesture controlled (light off, light on, dim light, change colour temperature, couple and decouple direct and indirect lighting) – making washing the hands before using a light switch a thing of the past.

## Compact 2-in-1 lighting

The linear pendant light can be used as either an indirect ambient light above the dining table or a direct light source above a cooktop – a compact '2-in-1 light' with the highest lighting quality. The five colour temperature settings and the infinitely adjustable dimmer function create a pleasant atmosphere in any cooking situation.

## High quality and aesthetically pleasing

The BORA Horizon linear pendant light dangles above worktops, cooktops or the dining table and blends discreetly into the overall kitchen environment, adding a touch of refinement. The light is available in three colours: soothing moss green, elegant black and picturesque rose gold. The high-quality BORA Horizon facilitates a clear view of the best food in good company.

## Top performance

BORA lighting rounds off the unified solution, which features the cooktop and extractor hood as well as functional and emotional lighting in the kitchen space, and allows for maximum design freedom. Meals can be prepared in ideal lighting and eaten in a pleasant atmosphere.

## Easy installation

All BORA pendant luminaires are designed for quick and easy installation. The luminaires are supplied fully assembled and only need to be mounted on the ceiling and the power connection made. All pendant luminaires (except LSE) are supplied with a drilling template for easy positioning of the drill holes.



Colour variants



black



moss green



rose gold



**LHMSW**

Horizon pendant light move – black

**LHMMG**

Horizon pendant light move – moss green

**LHMRG**

Horizon pendant light move – rose gold



**LHFSW**

Horizon pendant light fixed – black

**LHFMG**

Horizon pendant light fixed – moss green

**LHFRG**

Horizon pendant light fixed – rose gold

# BORA Stars Highlights

## **Dimming for perfect lighting for any situation**

The BORA Stars models with three lights in a linear or circular arrangement can be steplessly dimmed using a rotary knob or a light switch and thus easily adapted to any given cooking situation. Create elegant lighting accents with the BORA Stars.

## **Variable system**

The BORA Stars can be custom installed in any kitchen. The vertical BORA Stars pendant light is available as an individual light in both a surface-mounted and a built-in version or with three lights in a linear or circular arrangement.

## **High quality and emotional**

The BORA Stars vertical pendant lights dangle above worktops, cooktops or the dining table and blend discreetly into the overall kitchen environment, adding a touch of refinement. The light is available in three colours: soothing moss green, elegant black and picturesque rose gold. Dine as though under the starry sky with the high-quality BORA Stars.

## **Top performance**

BORA lighting rounds off the unified solution, which features the cooktop and extractor hood as well as functional and emotional lighting in the kitchen space, and allows for maximum design freedom. Meals can be prepared in ideal lighting and eaten in a pleasant atmosphere.

## **Easy installation**

All BORA pendant luminaires are designed for quick and easy installation. The luminaires are supplied fully assembled and only need to be mounted on the ceiling and the power connection made. All pendant luminaires (except LSE) are supplied with a drilling template for easy positioning of the drill holes.



#### Colour variants



black



moss green



rose gold



### LSLSW

Stars pendant light 3-light linear – black

### LSLMG

Stars pendant light 3-light linear – moss green

### LSLRG

Stars pendant light 3-light linear – rose gold



### LSZSW

Stars pendant light 3-light circular – black

### LSZMG

Stars pendant light 3-light circular – moss green

### LSZRG

Stars pendant light 3-light circular – rose gold



### LSASW

Stars pendant light surface-mounted – black

### LSAMG

Stars pendant light surface-mounted – moss green

### LSARG

Stars pendant light surface-mounted – rose gold



### LSESW

Stars pendant light built-in – black

### LSEMG

Stars pendant light built-in – moss green

### LSERG

Stars pendant light built-in – rose gold

## LHMSW / LHMMG / LHMRG

Horizon pendant light move – black  
 Horizon pendant light move – moss green  
 Horizon pendant light move – rose gold

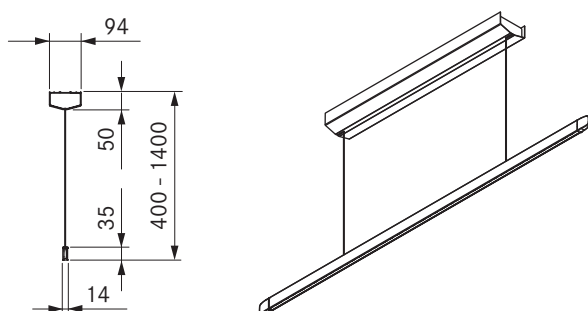
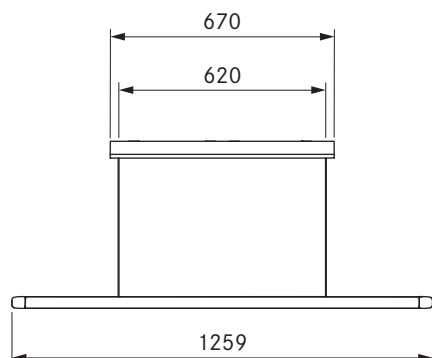

### Technical data

Lighting type	Pendant light
Supply voltage	220 - 240 V
Frequency	50 - 60 Hz
Maximum power consumption	40 W
Connection clamp	3 pole
Lighting control system	Gesture control
Dimmable	Yes
Bulb	LED
Light colour	warm white - cool white
Colour temperature	2700 K - 5000 K
Lux	1600 lm direct / 770 lm indirect
Direct beam angle	63°
Indirect beam angle	69°
Service life	> 50000 h
Switching cycles	min. 50000
Surface material	Metal / Plastic
Protection class	1
Protection rating	IP 20
Ceiling housing dimensions (W x D x H)	670 x 94 x 50 mm
Light dimensions (W x D x H)	1259 x 14 x 35 mm
Weight (incl. accessories/packaging)	4,4 kg
Power consumption in standby mode	< 0.5 W

### Product description

- High quality and aesthetically pleasing
- Compact 2-in-1 lighting
- Simple operation through gesture controls
- Steplessly height-adjustable on the lighting fixture

### Scope of delivery

- Horizon pendant light move
- Operating and installation instructions
- Drilling template

### Product- and planning instructions

- Fixing elements must be provided at the installation site

## LHFSW / LHFMG / LHFRG

Horizon pendant light fixed – black  
 Horizon pendant light fixed – moss green  
 Horizon pendant light fixed – rose gold

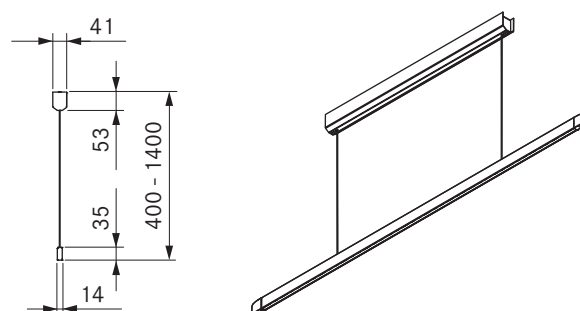
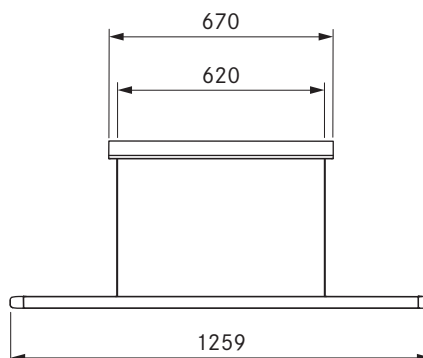

### Technical data

Lighting type	Pendant light
Supply voltage	220 - 240 V
Frequency	50 - 60 Hz
Maximum power consumption	40 W
Connection clamp	3 pole
Lighting control system	Gesture control
Dimmable	Yes
Bulb	LED
Light colour	warm white - cool white
Colour temperature	2700 K - 5000 K
Colour rendering index (Ra)	CRI > 90
Lux	1600 lm direct / 770 lm indirect
Direct beam angle	63°
Indirect beam angle	69°
Service life	< 50000 h
Switching cycles	min. 50000
Surface material	Metal / Plastic
Protection class	1
Protection rating	IP 20
Ceiling housing dimensions (W x D x H)	670 x 41 x 53 mm
Light dimensions (W x D x H)	1259 x 14 x 35 mm
Weight (incl. accessories/packaging)	4,9 kg
Power consumption in standby mode	< 0.5 W

### Product description

- High quality and aesthetically pleasing
- Compact 2-in-1 lighting
- Simple operation through gesture controls
- Height-adjustable without tools

### Scope of delivery

- Horizon pendant light fixed
- Operating and installation instructions
- Drilling template

### Product- and planning instructions

- Fixing elements must be provided at the installation site

## LSLSW / LSLMG / LSLRG

Stars pendant light 3-light linear – black  
 Stars pendant light 3-light linear – moss green  
 Stars pendant light 3-light linear – rose gold

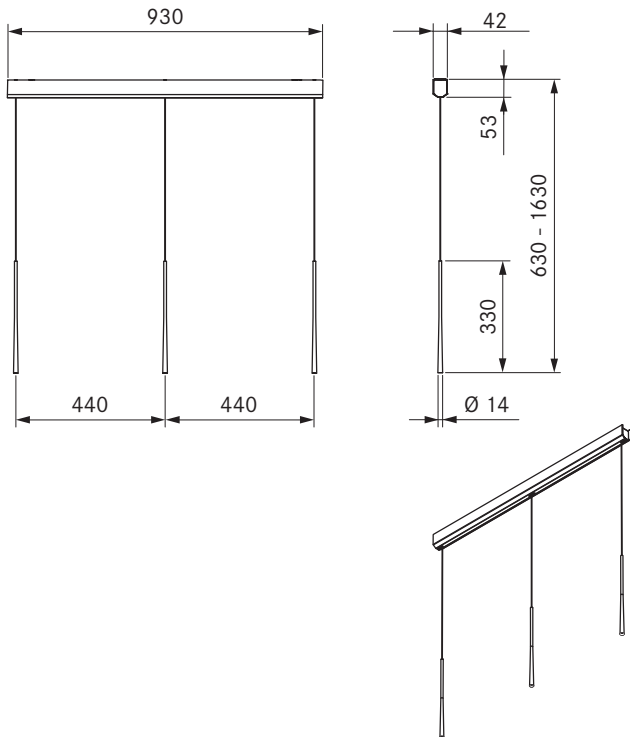

### Technical data

Lighting type	Pendant light
Supply voltage	220 - 240 V
Frequency	50 - 60 Hz
Maximum power consumption	10,5 W
Connection clamp	3 pole
Lighting control system	Pushbutton / DALI
Dimmable	Yes
Bulb	LED
Light colour	warm white
Colour temperature	2700 K
Colour rendering index (Ra)	CRI > 90
Lux	690 lm
Direct beam angle	46°
Service life	> 50000 h
Switching cycles	min. 50000
Surface material	Metal / Plastic
Protection class	1
Protection rating	IP 20
Ceiling housing dimensions (W x D x H)	930 x 42 x 53 mm
Light dimensions (D x H)	14 x 330 mm
Weight (incl. accessories/package)	4,2 kg
Power consumption in standby mode	< 0.5 W

### Product description

- DALI-controlled

### Scope of delivery

- Stars pendant light 3-light linear
- Operating and installation instructions
- Drilling template

### Product- and planning instructions

- Fixing elements must be provided at the installation site

## LSZSW / LSZMG / LSZRG

Stars pendant light 3-light circular – black  
 Stars pendant light 3-light circular – moss green  
 Stars pendant light 3-light circular – rose gold

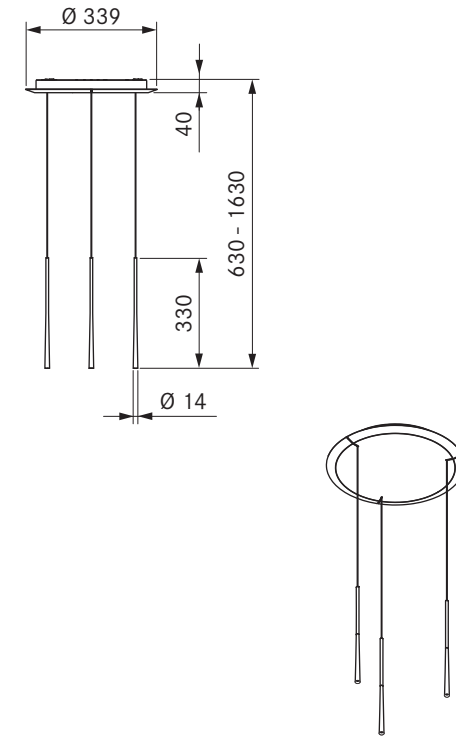

### Technical data

Lighting type	Pendant light
Supply voltage	220 - 240 V
Frequency	50 - 60 Hz
Maximum power consumption	10,5 W
Connection clamp	3 pole
Lighting control system	Pushbutton / DALI
Dimmable	Yes
Bulb	LED
Light colour	warm white
Colour temperature	2700 K
Colour rendering index (Ra)	CRI > 90
Lux	690 lm
Direct beam angle	46°
Service life	> 50000 h
Switching cycles	min. 50000
Surface material	Metal / Plastic
Protection class	1
Protection rating	IP 20
Ceiling housing dimensions (D x H)	393 x 40 mm
Light dimensions (D x H)	14 x 330 mm
Weight (incl. accessories/package)	3,6 kg
Power consumption in standby mode	0.5 W

### Product description

- DALI-controlled

### Scope of delivery

- Stars pendant light 3-light circular
- Operating and installation instructions
- Drilling template

### Product- and planning instructions

- Fixing elements must be provided at the installation site.

## LSASW / LSAMG / LSARG

Stars pendant light surface-mounted – black  
 Stars pendant light surface-mounted – moss green  
 Stars pendant light surface-mounted – rose gold

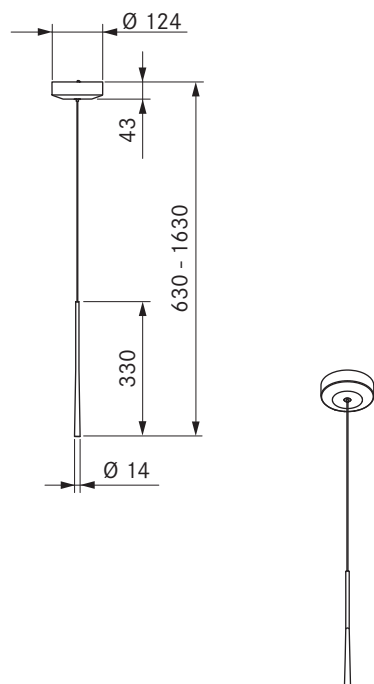

### Technical data

Lighting type	pendant light
Supply voltage	220 - 240 V
Frequency	50 - 60 Hz
Maximum power consumption	4,6 W
Connection clamp	3 polig
Dimmable	no
Bulb	LED
Light colour	warm white
Colour temperature	2700 K
Colour rendering index (Ra)	CRI > 90
Lux	230 lm
Direct beam angle	46°
Service life	> 50000 h
Switching cycles	min. 50000 h
Surface material	metal / plastic
Protection class	1
Protection rating	IP 20
Ceiling housing dimensions (D x H)	124 x 42 mm
Light dimensions (D x H)	14 x 330 mm
Weight (incl. accessories/packaging)	1,3 kg

### Product description

- Height-adjustable without tools

### Scope of delivery

- Stars pendant light surface-mounted
- Operating and installation instructions
- Drilling template

### Product- and planning instructions

- Fixing elements must be provided at the installation site

## LSESW / LSEMG / LSERG

Stars pendant light built-in – black  
 Stars pendant light built-in – moss green  
 Stars pendant light built-in – rose gold

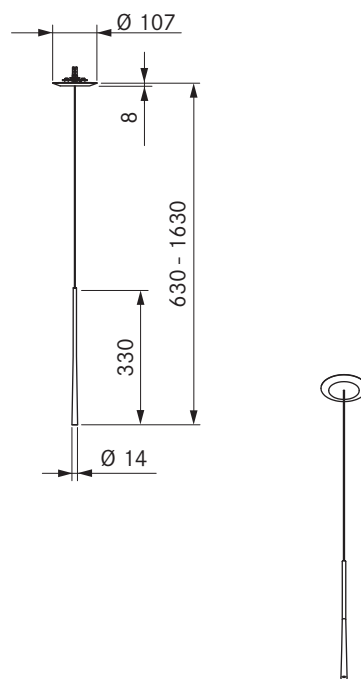

### Technical data

Lighting type	pendant light
Supply voltage	220 - 240 V
Frequency	50 - 60 Hz
Maximum power consumption	4,6 W
Connection clamp	2 pin
Dimmable	no
Bulb	LED
Light colour	warm white
Colour temperature	2700 K
Colour rendering index (Ra)	CRI > 90
Lux	230 lm
Direct beam angle	45°
Service life	> 50000 h
Switching cycles	min. 50000
Surface material	metal / plastic
Protection class	3
Protection rating	IP 20
Ceiling housing dimensions (D x H)	107 x 8 mm
Light dimensions (D x H)	14 x 330 mm
Weight (incl. accessories/packaging)	1,2 kg

### Product description

- Flush installation

### Scope of delivery

- Stars pendant light built-in
- Operating and installation instructions
- Control gear LED driver SK II

### Product- and planning instructions

- LSE can be integrated into a lighting control system using a suitable control gear (not included)



# Radiation of light

BORA Horizon

## Distances, luminous intensity and beam angle

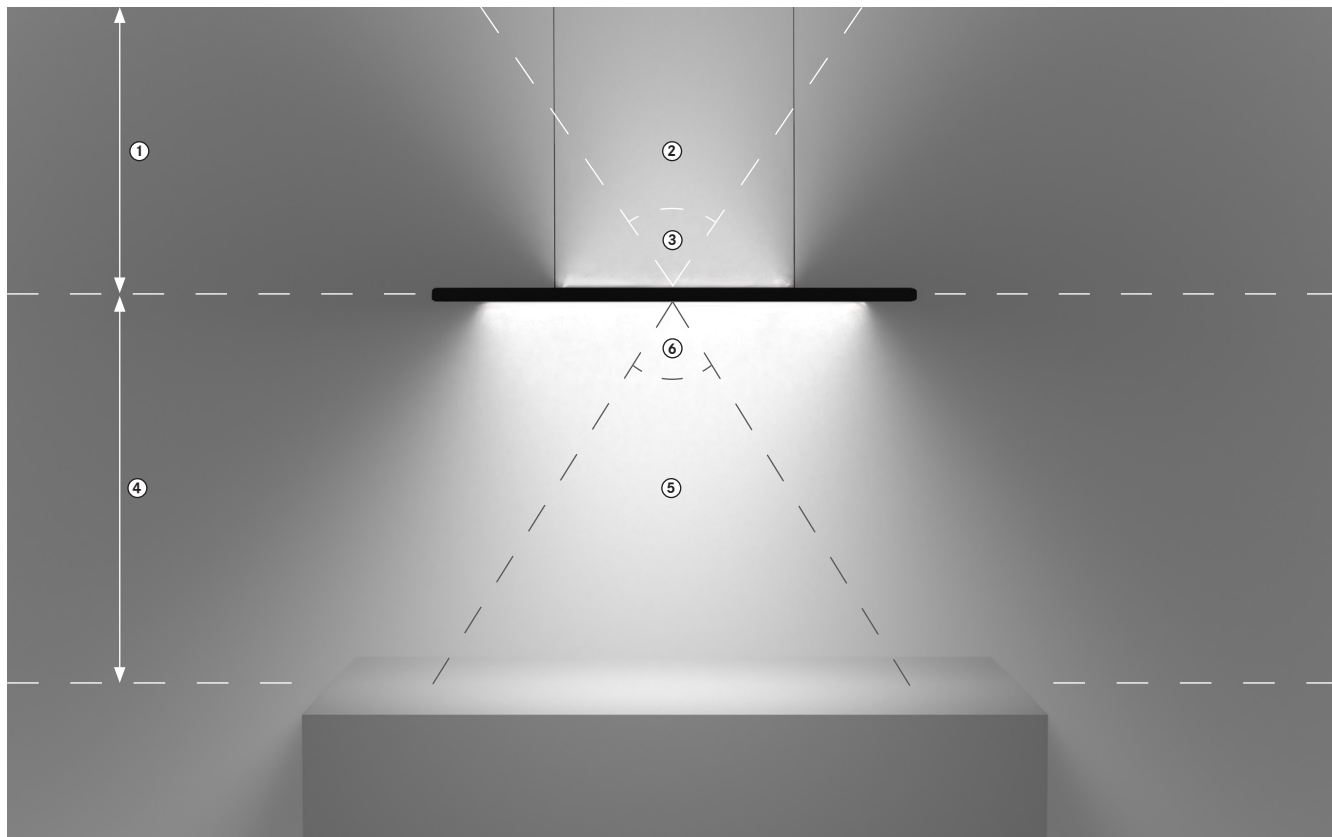

### Indirect lighting:

- ① Optimum distance to the ceiling = 0,5 – 1,5 m (given by cable length)
- ② Luminous intensity = 475 lx (at a distance of 1 m)
- ③ Beam angle = 69°

### Direct lighting:

- ④ Optimum distance to the surface = 1,0 – 2,0 m (approx. 475 lx)
- ⑤ Luminous intensity = 1304 lx (at a distance of 1 m), 326 lx (at a distance of 2 m)
- ⑥ Beam angle = 63°



# Radiation of light

BORA Stars

## Distances, luminous intensity and beam angle

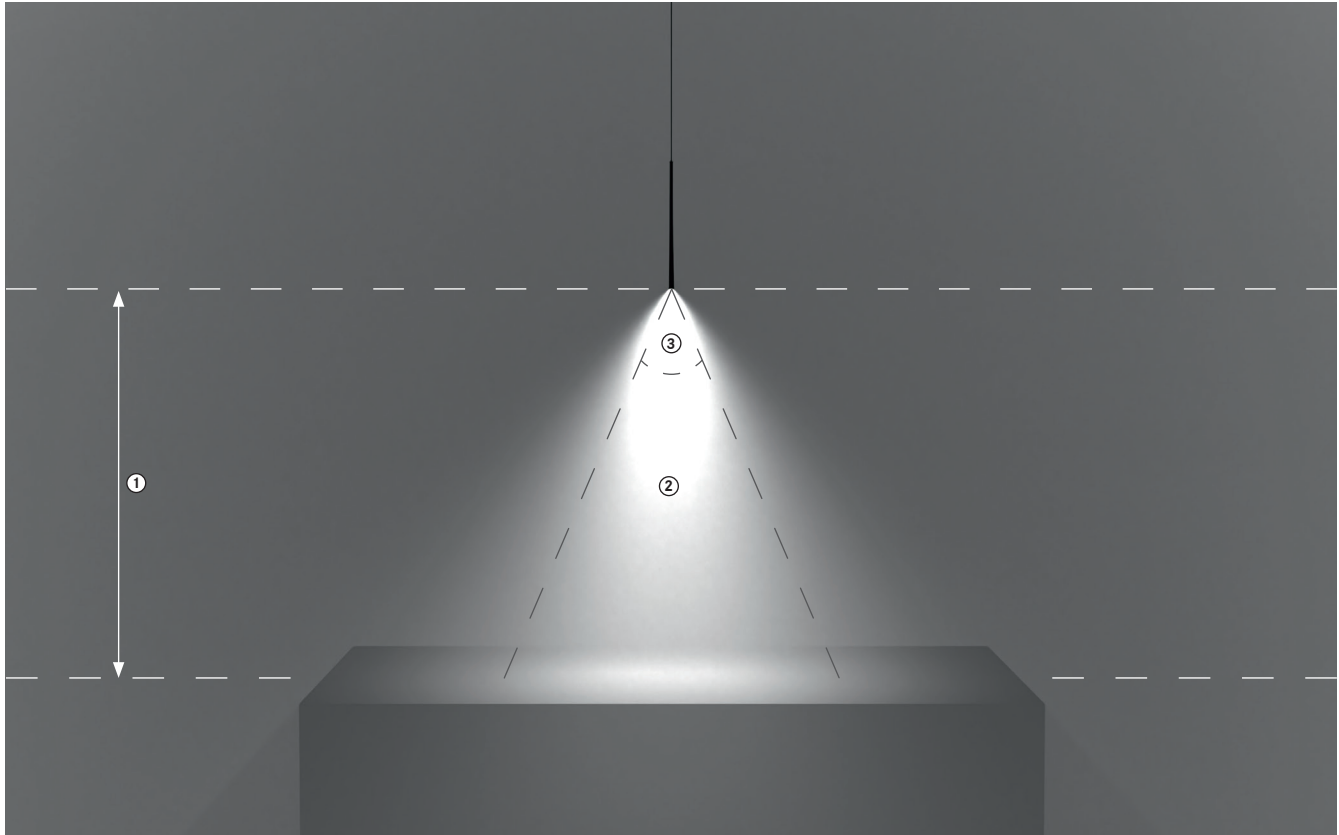

### Direct lighting:

- ① Optimum distance to the surface = 1,0 – 1,5 m
- ② Luminous intensity = 328 lx (at a distance of 1 m)
- ③ Beam angle = 46°

## Empfehlungen für die Lichtplanung

Richtwerte für die Beleuchtungsstärke

Ambiente-Beleuchtung	Ess- und Wohnbereich	über Kochfeld / Arbeitsplatte
50 – 200 Lux	200 – 300 Lux	300 – 500 Lux





BORA Lüftungstechnik GmbH  
Rosenheimer Straße 33  
D-83064 Raubling, Germany  
T +49 (0) 80 35 98 40-0  
F +49 (0) 80 35 98 40-300  
info@bora.com



BORA Vertriebs GmbH & Co KG  
Innstraße 1  
A-6342 Niederndorf, Austria  
T +43 (0) 53 73 6 22 50-0  
F +43 (0) 53 73 6 22 50-90  
mail@bora.com



BORA Holding GmbH  
Innstraße 1  
A-6342 Niederndorf, Austria  
T +43 (0) 53 73 6 22 50-0  
F +43 (0) 53 73 6 22 50-90  
mail@bora.com

EN

Errors and technical changes reserved.

Due to ongoing improvements thanks to research and development, BORA reserve the right to change product specifications or features without prior notice. BORA shall not be held liable for printing errors. Publication of images and diagrams requires written authorisation.

[bora.com](https://bora.com)